

# Diamond Led Lighting Cloud App

## User Manual

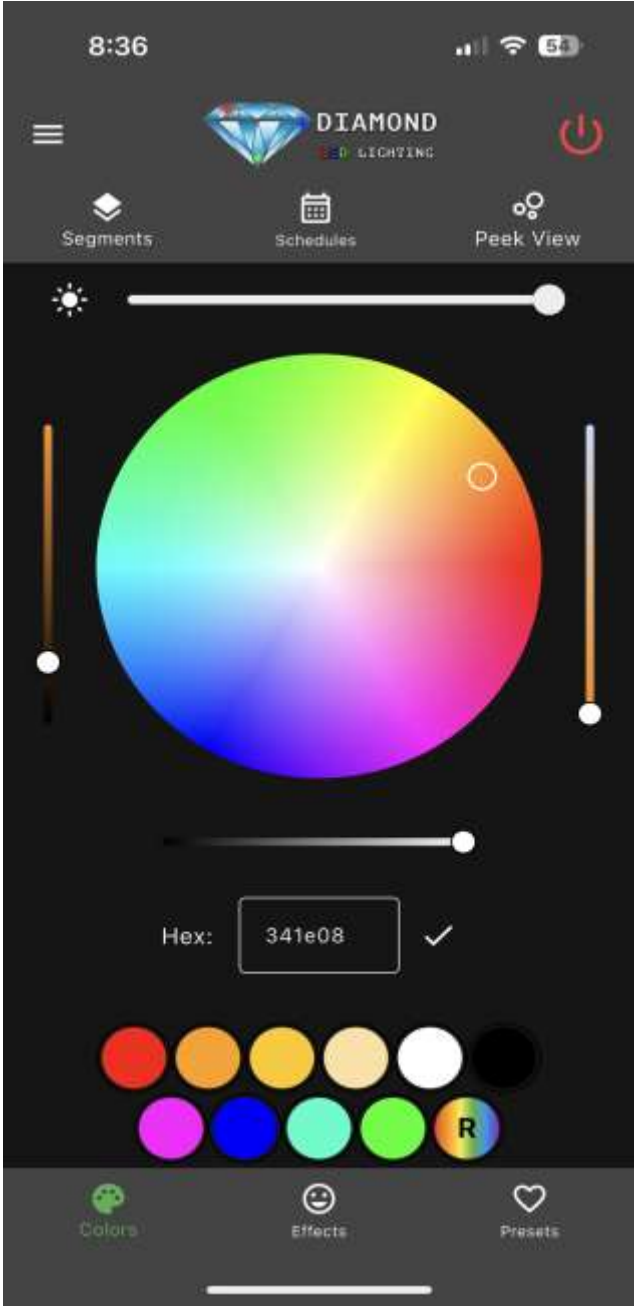

# Color wheel

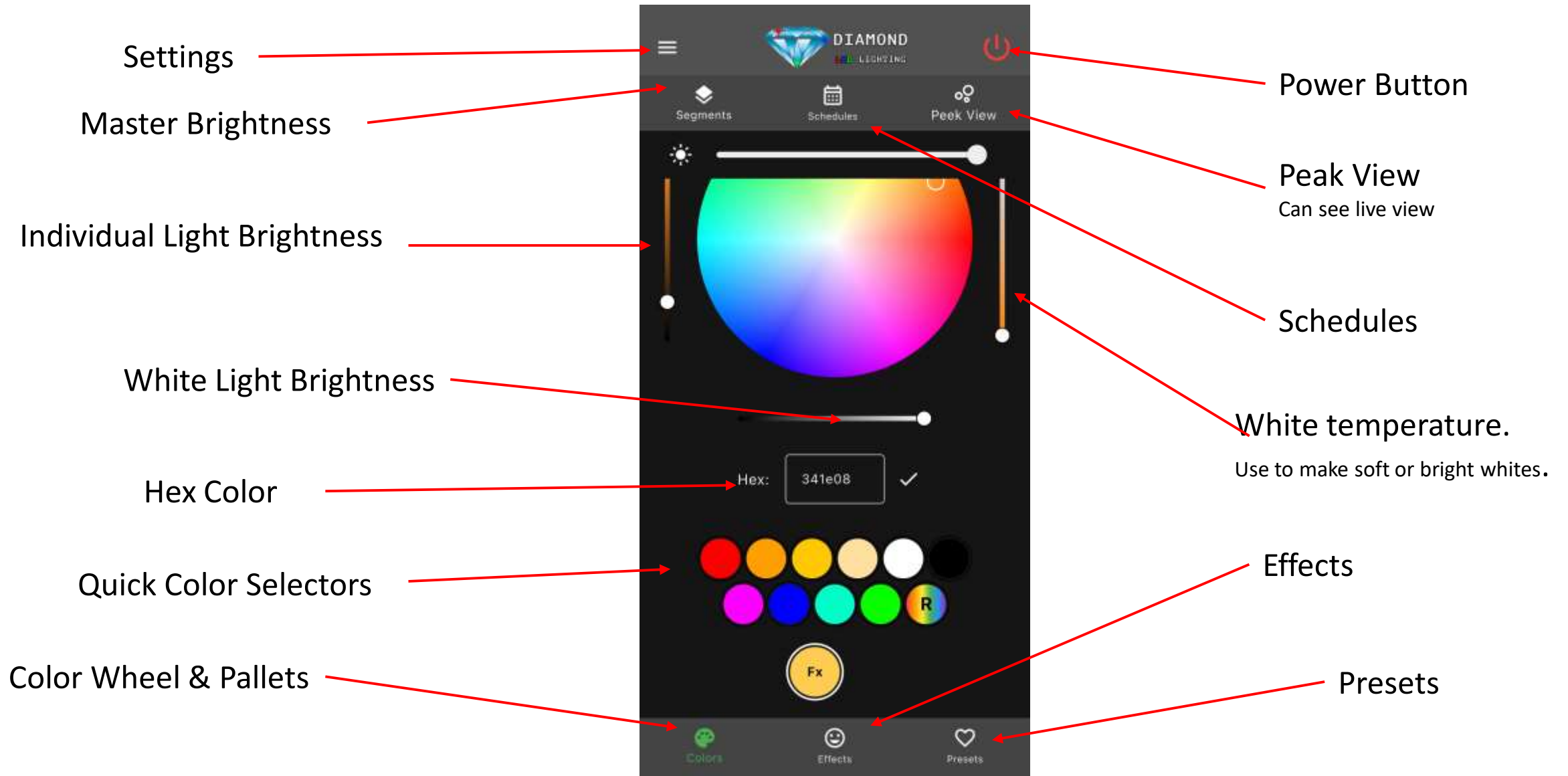

# Effects

- The effect tab is full of prebuilt effects that you can use and customize to make your own.
- Most great presets start with an effect, choose an effect and modify the speed and intensity with the sliders.
- In the color wheel you can adjust the colors of the effects to really make it your own.

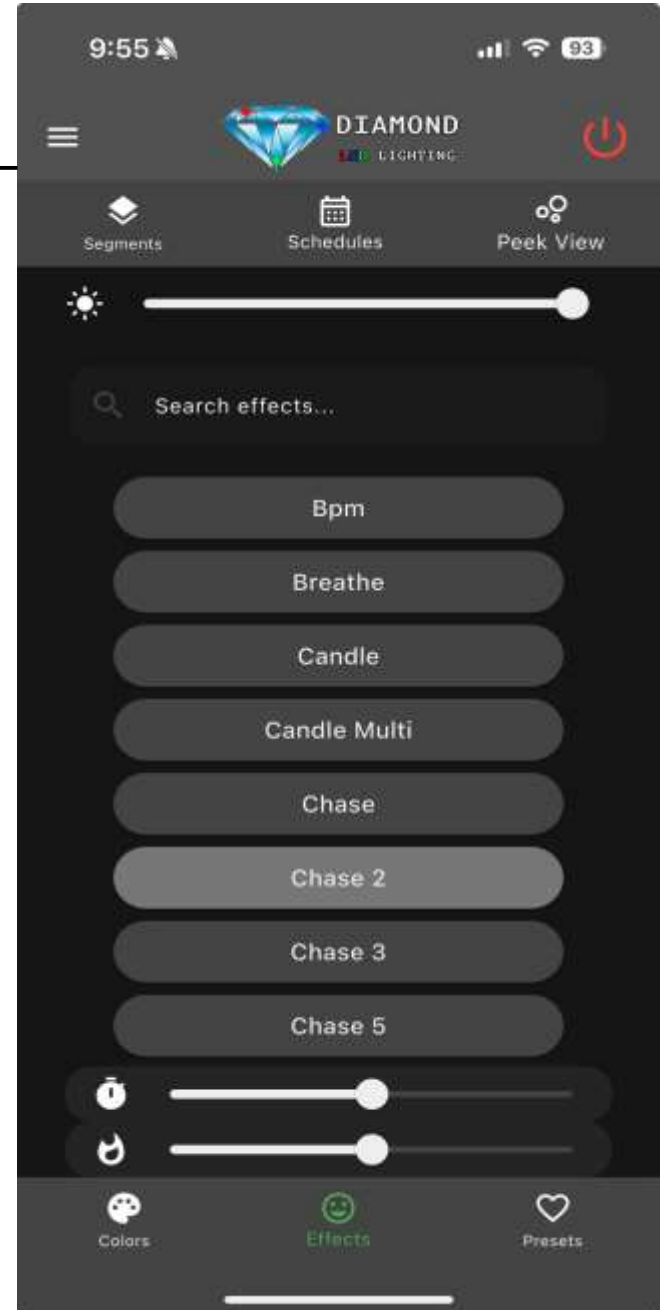

# PRESETS

---

- **Global presets** are controlled by Diamond Led Lighting and are read only. You can't save your own presets to this folder.
- Click on a preset to have the effect automatically loaded on your lights.
- **Location Presets** are presets that you create and can be saved to this folder.

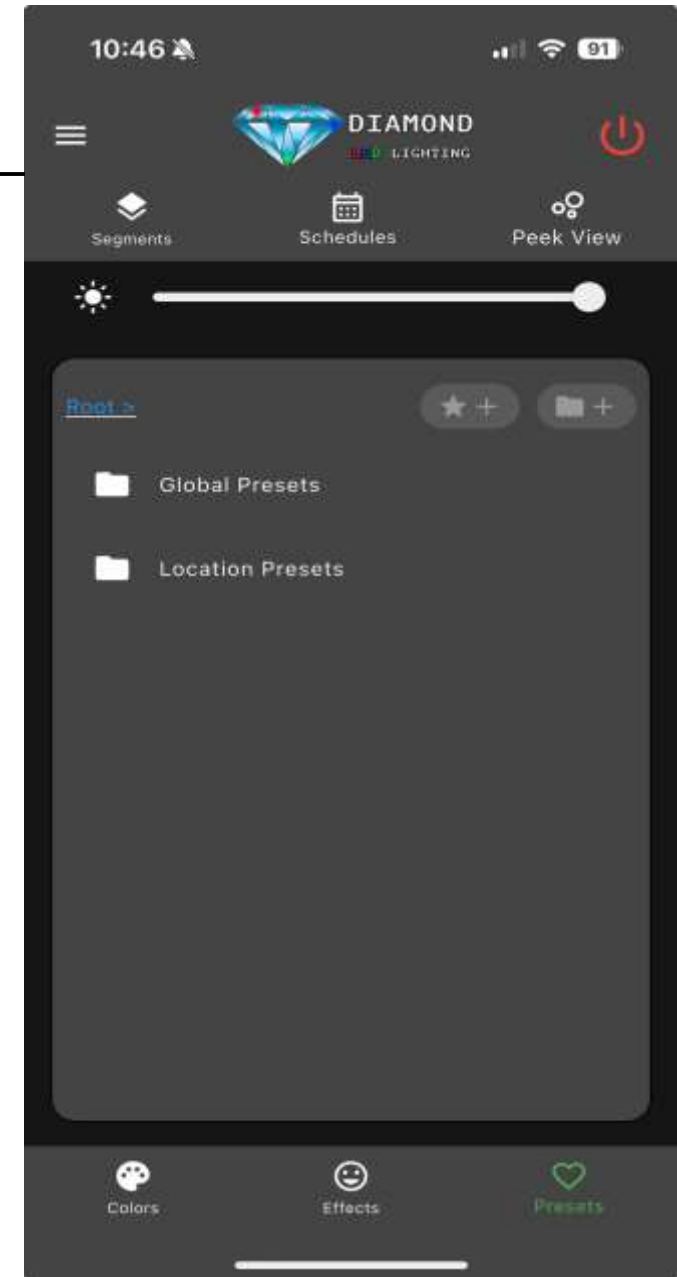

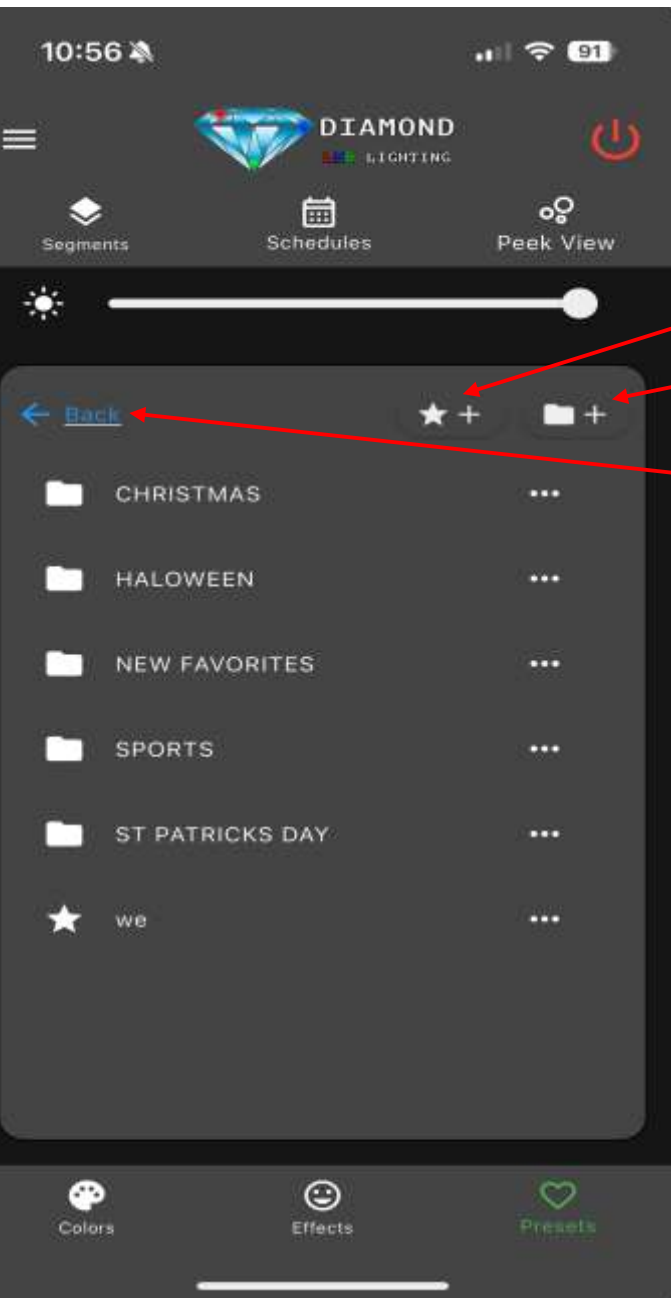

# Saving Presets

Create Preset

Create Folder

Click the root folder or back button to go back a folder

- Once you have created a custom lighting pattern that you want to save as a preset go to location presets and click the star button to create a preset.
- Give the new preset a name.
- You can also create folders and organize your presets into folders.
- If you incorporated segments into your light pattern, make sure you check the “save segment bounds” box.
- To go back click on the “root” folder to go back to the preset main screen.

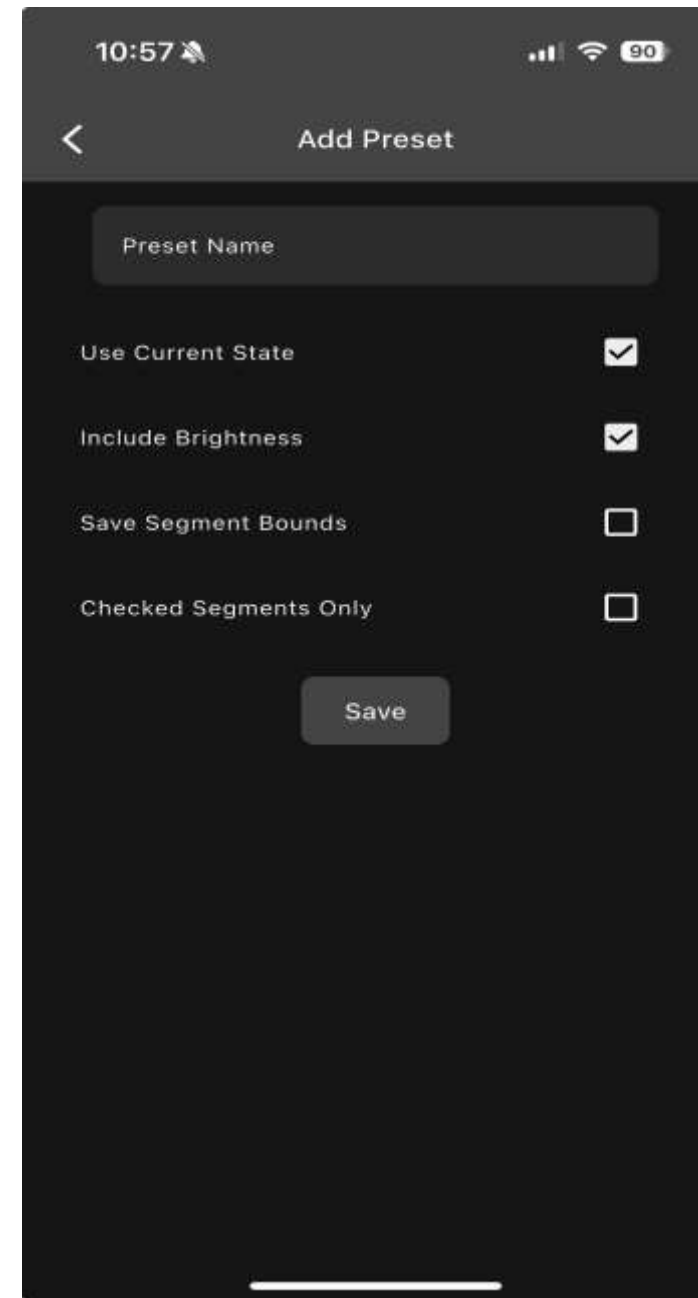

# Schedules

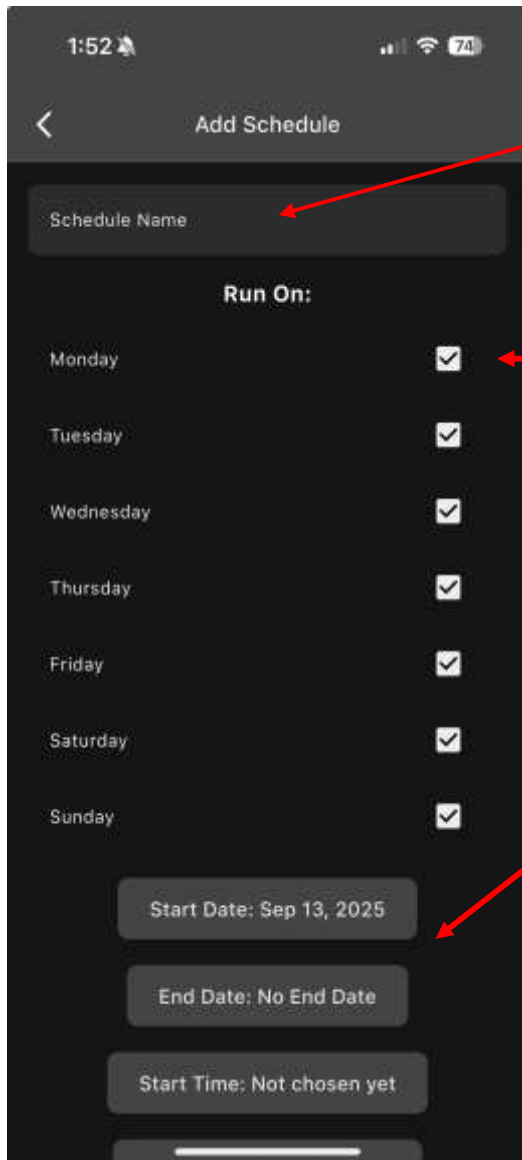

Give the schedule a name

Select the days of the week you want the schedule to run

Select a start date and an end date if you want, or leave it to have it run all the time

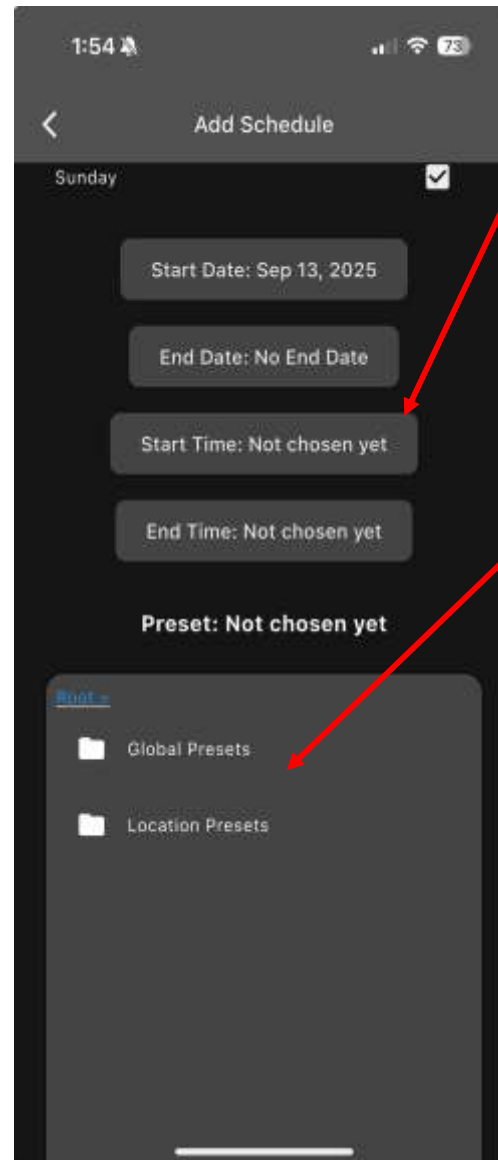

Select start and end time, sunset/sunrise will automatically change based on your location.

Select the preset you want to run in the schedule

Select the controllers you want to run with the schedule

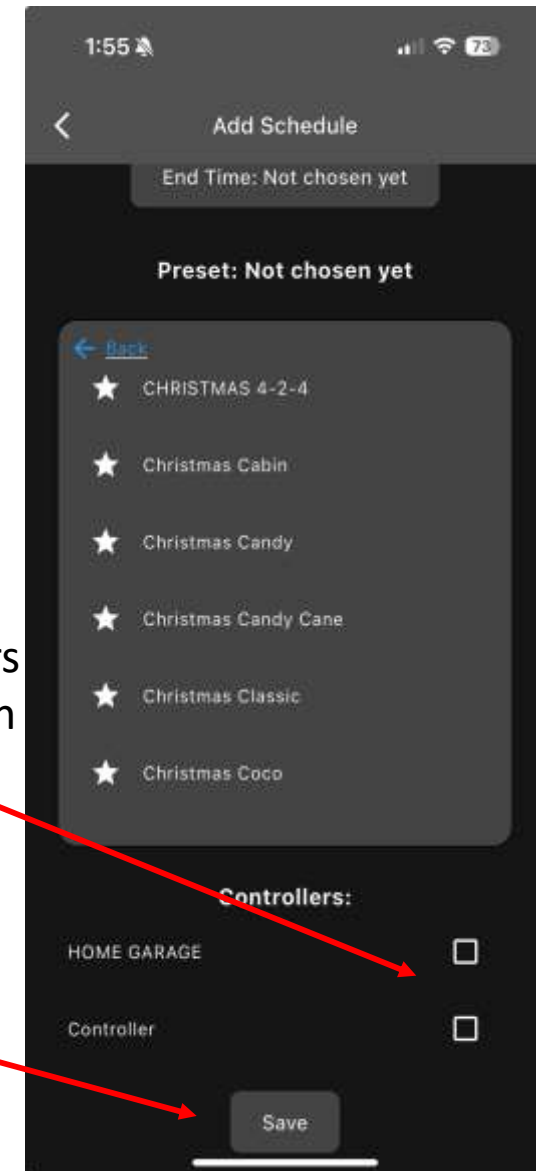

Save

# Schedules

- Segments are a next level tool to really get creative with lighting designs. With segments you can decide what lights you want on or off and even run different effects on different parts of your house.
- To get a good understanding about segments watch this video. (coming soon)

- The number of lights you want off between each group
- How many lights you want to group together.
- Brightness control for each segment

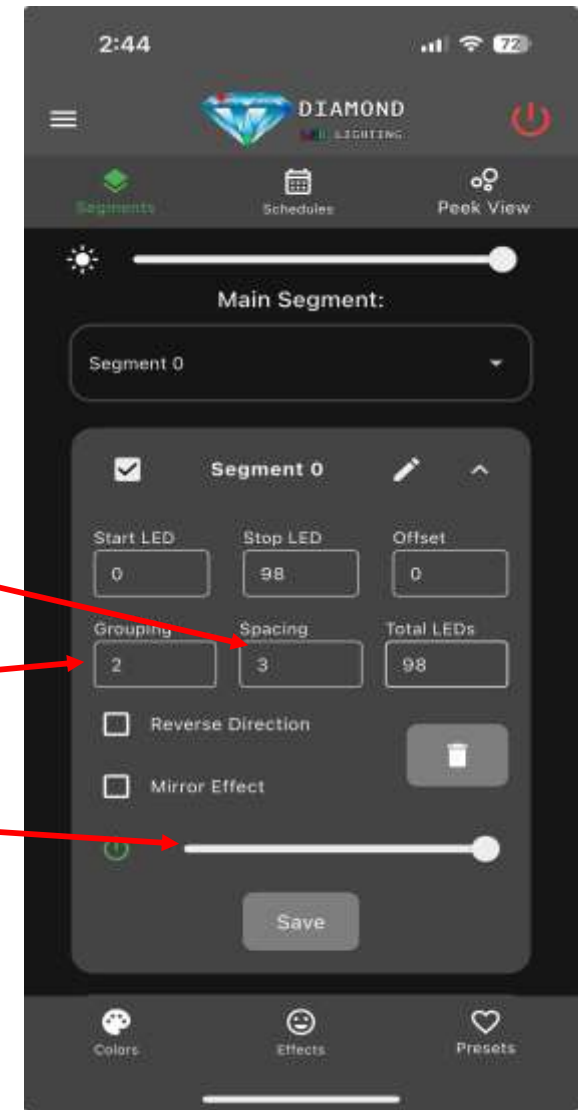

# Segments continued..

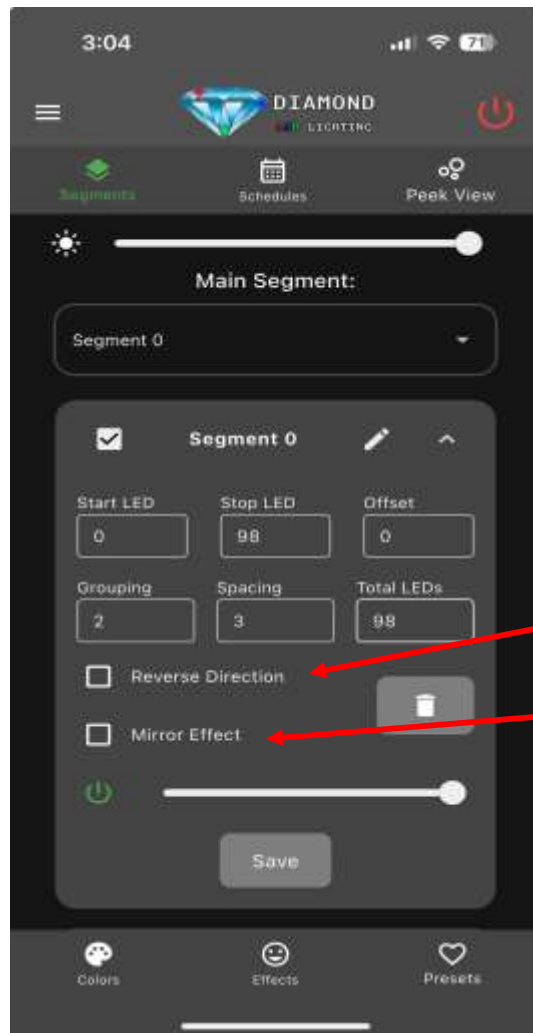

- To change the color of a segments or add an effect, click the checkbox beside the segment you want to change then go to the color wheel to change the color.
- If you select multiple segments the color changes you make will be applied to all checked segments.
- Use the slider to adjust the direction of the lights
- Mirror effect will make the lights start in the middle of the segment and flow outwards
- Always Reset to One Segment when going to use new effects

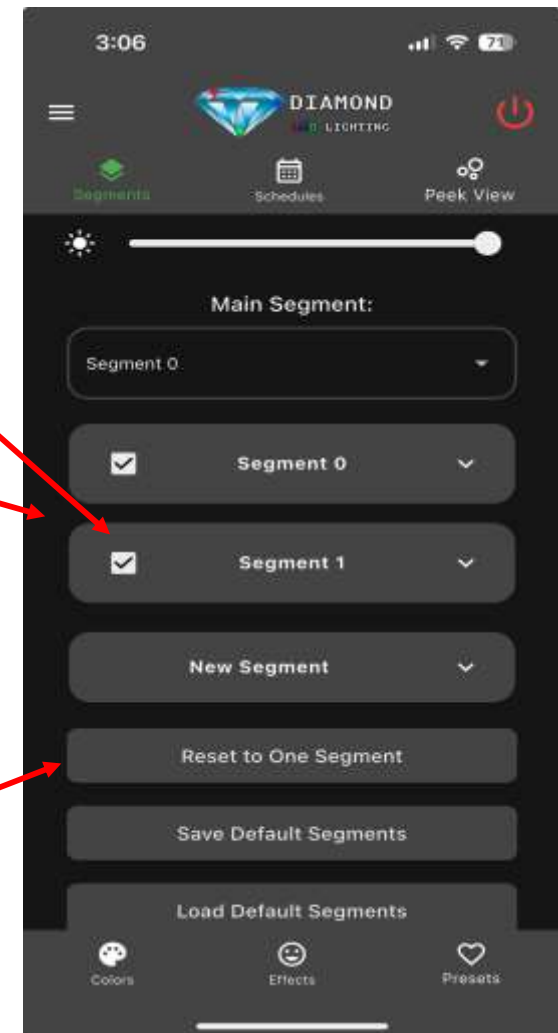

# Location Settings

- Here is where you set where your controller is located and who has access to control your lights.
- You can add a user by entering the e-mail address of the person you want to add. It needs to be the email address that they registered on the app.
- If you move and take your controller with you, you can change the location at the bottom of the screen.

The location name

Other people who I gave access to control my lights

Add more users to the location

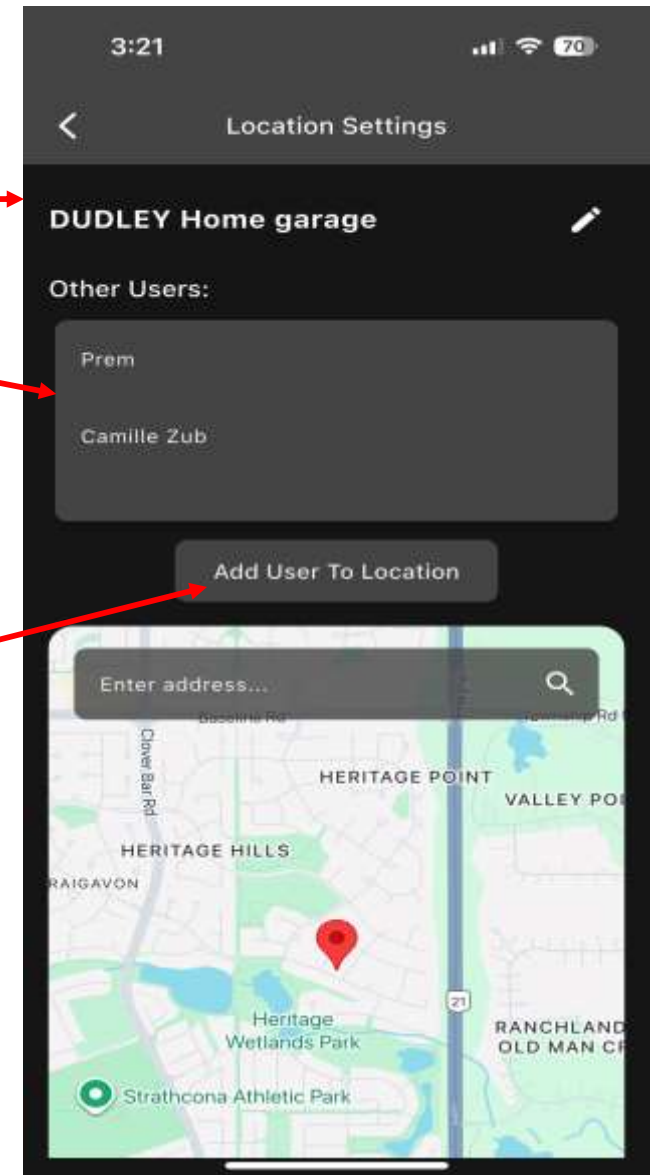

# Locations

---

The locations screen shows the locations that you have access to .  
“Dudley Home ” is my controller. If you click on the location and go  
back to the app you see the presets and schedules for that specific  
location.

If you have another location of a controller, say at a cabin or lake  
lot you would add it here.

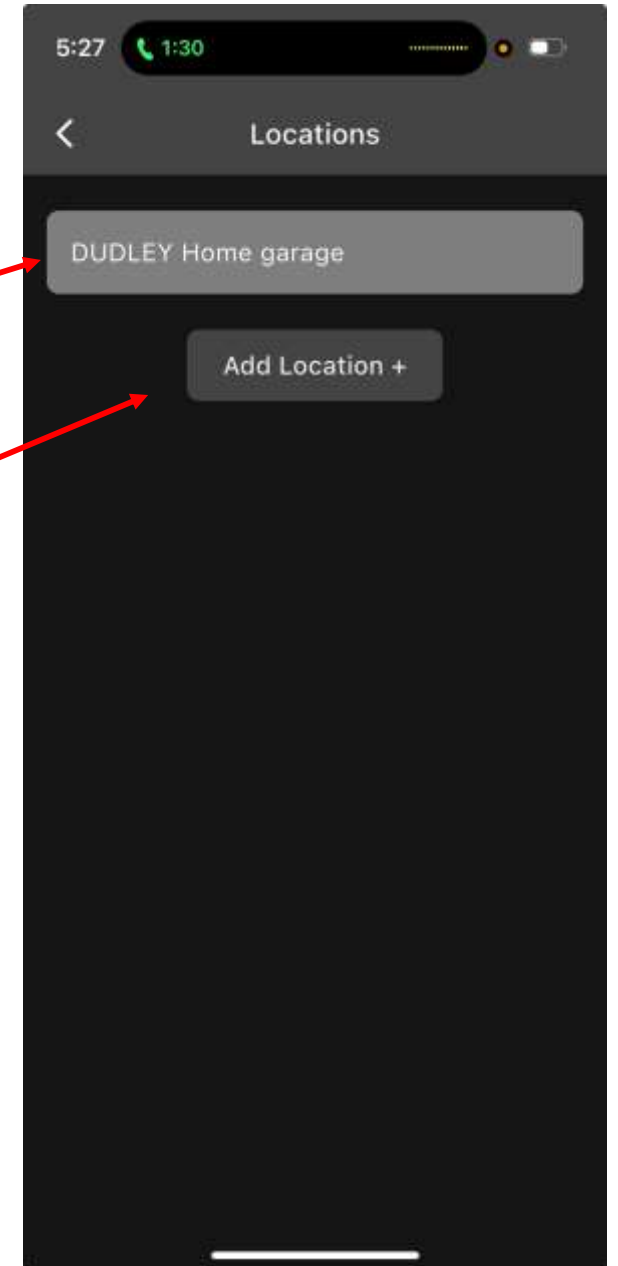

# Controller settings

- The controller settings screen shows the controllers that you have in a location.
- You can activate or deactivate controllers from this screen, as well as edit the name of the controller, add new controllers or edit the controller.
- When a controller is enabled any changes you make to colors or effects will only display on the selected controllers.

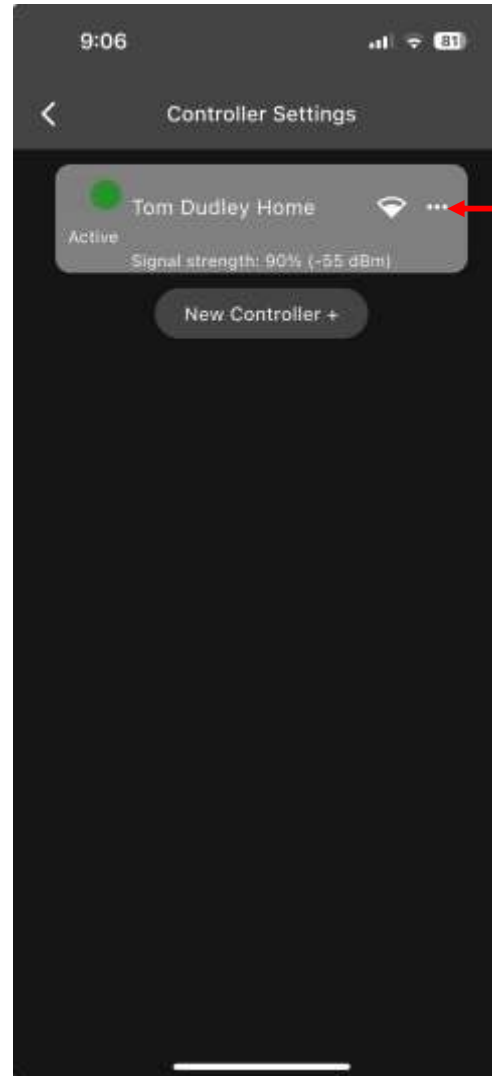

Click here and tap edit to open your LED settings to change LED count (Length) or add/remove controller outputs. **Note:** you will need to connect back to the controllers Wi-Fi to open the LED settings screen.

